

FOR LEASE

HIGH EXPOSURE RETAIL/OFFICE/BANK SPACE

1515 N. Academy Blvd • Colorado Springs



- Central Academy Market - Near Citadel Mall
- Great Location – High Exposure
- PBC Zoning 87, 120 sq. ft. Lot
- Ideal for Financial Services, Real Estate, Medical
- Four Story plus basement Building
- High Traffic for Retail or Bank
- Multiple Lane Drive up Banking Facility



See us on the web at

www.firstproperties1.co

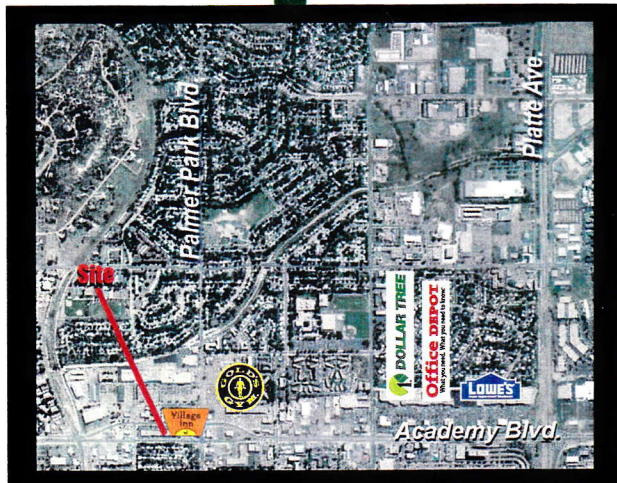

Contact: Richard L. Walker - Rwalker@firstproperties1.co
1-719-576-2288

First Properties, Inc.
444 E. Pikes Peak Ave. Suite 200
Colorado Springs, CO 80903



Site Plan

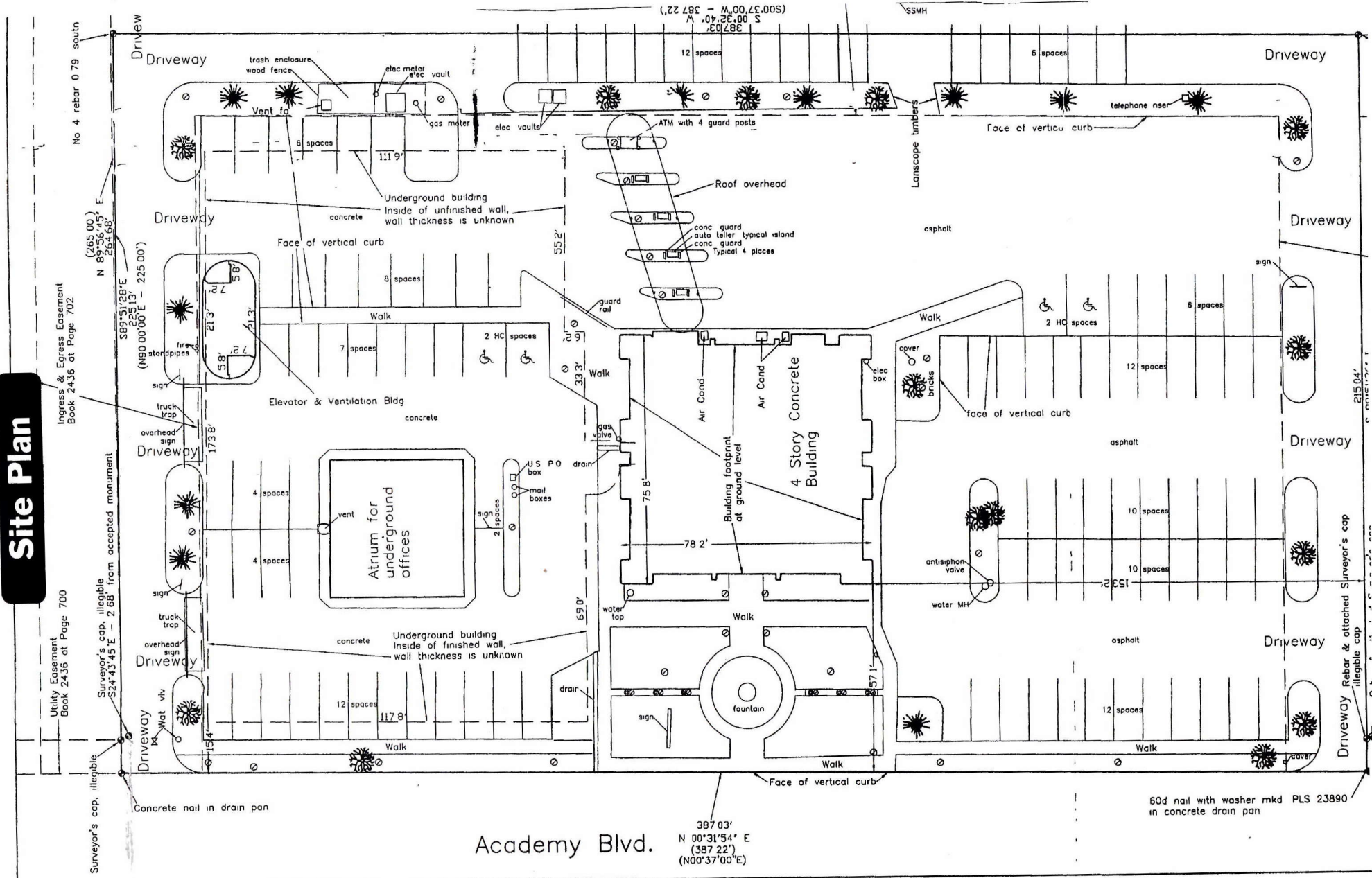

Academy Blvd.

387.03'
N 00°31'54" E
(387.22')
(N 00°37'00" E)

60d nail with washer mkd PLS 23890
in concrete drain pan